

DIFFERENTIAL PRESSURES GAUGES

FLOW

**FILTER
HEAD-LOSS**

**GAS AND LIQUID
APPLICATIONS**

**VISUAL INDICATION
AND ELECTRICAL
SWITCHING**



**METAL
PRESSURE ELEMENTS**

**FULL OVERLOAD
PROTECTION**

**BRONZE OR
STAINLESS STEEL**

Widely used to indicate and alarm in flow and pressure drop application, suitable for liquid and gases.

J Series uses twin opposed Bourdon tubes and covers differentials from 60 kPa through 2,500 kPa at line pressures up to 25,000 kPa. Full overload protection – maximum line pressure can be applied to either side without damage.

Electrical contacts can be fitted where the ratio of line to differential pressure does not exceed 4:1 with Lo/Hi, or Hi and Lo options. The dial is normally calibrated in pressure units but can be supplied in any customer preferred calibration.

SPECIFICATION

| | |
|---------------|---|
| Size: | 100 and 150mm |
| Wetted Parts: | Brass/Bronze or Stainless Steel |
| Case: | Steel Acrylic finish or Stainless Steel |
| Window: | 3mm Glass |
| Element: | Opposed Bourdon Tube |
| Accuracy: | 2.0% of Differential range |
| Overload: | Protected up to 20,000 kPa |
| Connections: | 3/8" BSP Twin bottom |
| Weight: | 1Kg or 1.5 Kg |
| Movement: | Rack & Pinion |

**STANDARD RANGES AVAILABLE-OPTIONS:
FLOW CALIBRATION, CENTRE ZERO OR
COMPOUND SCALE**

| Max. line pressure | Min. differential pressure |
|--------------------|----------------------------|
| 600 kPa | 60 kPa |
| 1000 kPa | 100 kPa |
| 1600 kPa | 160 kPa |
| 2500 kPa | 160 kPa |
| 4000 kPa | 250 kPa |
| 6000 kPa | 600 kPa |
| 10000 kPa | 1000 kPa |
| 16000 kPa | 1600 kPa |
| 25000 kPa | 2500 kPa |

FLUSH MOUNTING

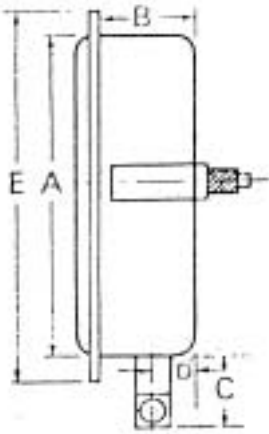

| | 100mm | 150mm |
|---|-------|-------|
| A | 106 | 147 |
| B | 33 | 31 |
| C | 29 | 29 |
| D | 15 | 15 |
| E | 124 | 166 |
| F | 133 | 188 |
| G | 121 | 175 |
| H | 108 | 150 |

F = OD of 3 hole fixing flange
 G = PCD of 3 holes
 H = Recommended panel cut out diameter

SURFACE MOUNTING

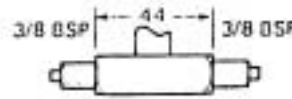
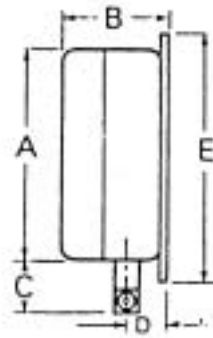

SURFACE MOUNTING

| | 100mm | 150mm |
|---|-------|-------|
| A | 106 | 148 |
| B | 43 | 40 |
| C | 29 | 29 |
| D | 18 | 18 |
| E | 130 | 183 |
| F | 116 | 168 |

F = PCD of flange holes.
 Dimension B varies up to a maximum of 120mm on some 150mm type K instruments.

ALTERNATIVE PRESSURE GAUGES



Measurement Resources provide an extensive range of pressure gauges including Military specification, general industrial and specialist gauges. All are backed by our in-house NATA accredited laboratory.



| CODE | DIAL SIZE IN MM | | | | | | |
|------|-----------------|--|------------------------------|-----------------------|-----------------------|---------|--------------------|
| 100 | 100 mm DIA. | | | | | | |
| 150 | 150 mm DIA. | | | | | | |
| | CODE | ELEMENT | | | | | |
| | J | Twin opposed tubes - High differential | | | | | |
| | | CODE | WETTED MATERIAL | | | | |
| | | A | Brass/Bronze | | | | |
| | B | Type 316 Stainless Steel | | | | | |
| | | | CODE | MOUNTING ARRANGEMENT | | | |
| | | | B | Surface | | | |
| | | E | Flush panel via clamp fixing | | | | |
| | | | | CODE | CASE MATERIAL | | |
| | | | | 3 | Steel Acrylic painted | | |
| | | | | 4 | Stainless Steel | | |
| | | | | DIFFERENTIAL PRESSURE | | | |
| | | | STATIC/LINE PRESSURE | | | | |
| 100 | J | B | B | 4 | 250 kPa | 4000kPa | Typical Order Code |



33 – 37 College Street
 P.O. Box 145 Gladesville NSW 2111 Australia
 Telephone: (61-2) 9816 3377 Fax: (61-2) 9816 3806
 Email: sydney@measurement-resources.com.au
 Website: www.measurement-resources.com.au